

MAINTENANCE

Before your journey, ensure your OPW CAGE is properly mounted.

The lifespan of the OPW CAGE will be influenced by the usage patterns and the humidity levels in the climate, it is recommended to clean and re-lubricate your OPW CAGE after each ride.

When traveling with your bike, it's advisable to remove the entire rear derailleur. This is due to the complexity of disassembling both the OPW CAGE and the rear derailleur, ensuring the protection of your OPW CAGE during transit.

HOW TO LUBRICANT YOUR PULLEYS

Apply a small amount of TRiPEAK lubricant against the edge of the bearing seal, to allow the lubricant to penetrate into the bearings for effective lubrication.

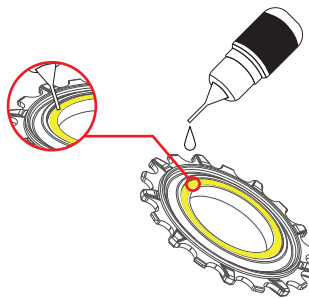

MAINTENANCE ADVICE

It is recommended to lubricate the pulleys while lubricating the chain or after washing the bike. Perform regular maintenance every six months.

 Lubrication has been applied to the pulleys. Please perform regular maintenance as needed.

DESCRIPTION

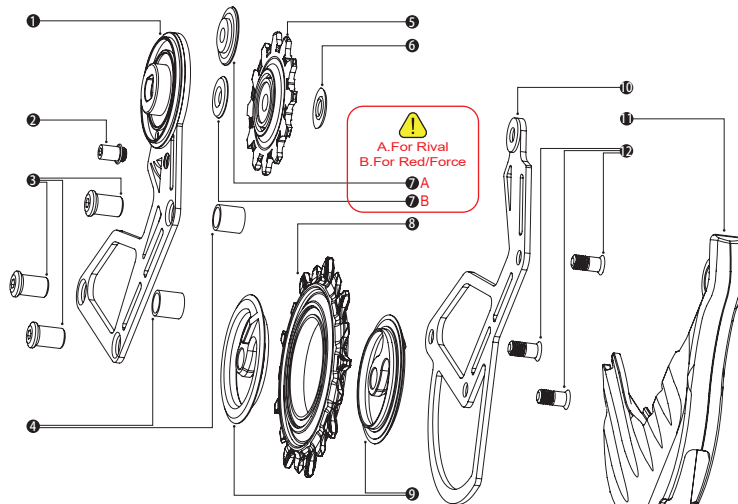

- | | | | |
|---------------|--------------------|---|----------------|
| 1 Outer Plate | 4 Bushing | 7 Pulley Outer Cap
A.For Rival B.For Red/Force | 10 Inner Plate |
| 2 Stopper Pin | 5 Guide Pulley | 8 Tension Pulley | 11 Aero Cover |
| 3 Plate Nut | 6 Pulley Inner Cap | 9 Tension Pulley Cap | 12 Plate Bolt |

THE TOOLS YOU NEED:



▲ Hex Key - 2.5mm



▲ Hex key - 3mm x 2



▲ Hex Key - 4mm



▲ 4 prong tool

JETSTREAM^{PRO}

AERO WING OPW CAGE

INSTALLATION MANUAL

FOR **SRAM**[®] RED E-TAP AXS
FORCE E-TAP AXS
RIVAL E-TAP AXS

 To ensure a better riding experience, it is recommended to have the assembly of the TRiPEAK OPW CAGE performed by a professional or bicycle shop.

STEP 1



Remove the original derailleur cage and keep the original tension spring, axle retaining ring, and upper pulley screws.

Disassemble the TRiPEAK OPW cage, leaving only the outer plate.

STEP 2



Align the flat surface of the D-shaped fixing shaft inside the derailleur body with the tension spring's fixing hook.

Hook the outer plate onto the spring's fixing hook and rotate it clockwise onto the D-shaped fixing shaft and push into fixed.

STEP 3



Use the 4 prong tool with 4mm hex wrench to lock the axle retaining ring (max.5Nm), securing the outer plate against & flat against the derailleur body.

STEP 4



Turn the derailleur to the front. Rotate the outer plate counterclockwise until the fixing hole of the stopper pin is visible, then tighten the stopper pin using a 2.5mm hex key.

! At this step, the outer plate may rebound, please handle it with care to prevent injury.

STEP 5



Flip to the rear of the derailleur, install the tension pulley cover, tension pulley, and inner plate. Insert the nut from the outer plate side and the screw from the inner plate side, then gently tighten the fixing screw with two 3mm hex keys.

! Ensure that the latch of the cap circled in red in the picture, is properly inserted.

STEP 6



Secure the upper pulley with the screws removed from the derailleur, using a 2.5mm hex key to tighten.

! Ensure that the pulleys are oriented with the logo facing outward.

STEP 7



Insert the bushings between the inner and outer plates, then gently tighten the screws.

Secure all 4 fixing screws (max. 4Nm) to complete the installation.

AERO COVER INSTALLATION

STEP 1

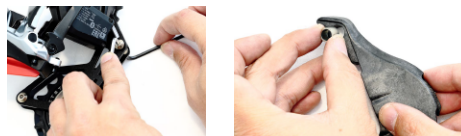

Using two 3mm hex keys to remove the plate nut, plate bolt, and bushing from front-end fixing hole.

Insert the bushing into the fixed hole of the Aero Cover.

STEP 2



From the front end, gently push the Aero Cover into the OPW cage, insert the nut & bolt, then tighten them(max.4Nm) to complete the installation of the Aero Cover.



! Ensure that the clasps on the front and rear of the Aero cover are flat against the front and rear plates.